

### Tank fixing plate

Stainless steel bracket for tanks with specific predisposition  
Prepared with 2 slotted holes for screws.

Code	Compatible with tanks
52.195.00	50.147.xx; 50.148.xx; 50.149.xx; 52.194.xx; 52.194.21

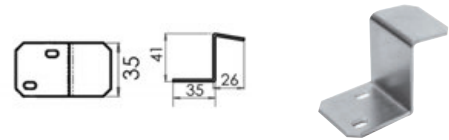

### H2O / fuel tap plug for stainless steel, plastic and aluminium tanks

Made of nylon, fitted with a stainless steel tap plug elbow-shaped hose.  
Easy to fix on any flat surface by boring a 5-cm hole.

Code	Version
52.199.02	Pipe Ø 12 mm, length 56 cm, bore Ø 50 mm
52.199.14	Pipe Ø 14 mm, length 84 cm, bore Ø 50 mm



### 90° outlet for flexible water tank

Made of **nylon** with 90° pipe, ideal for flexible water tanks 52.196.xx.

Code	Version
52.196.91	Outlet or vent, hose adaptor Ø 16 mm
52.196.93	Load, hose adaptor Ø 38 mm



### 90° outlet for rigid water tank

Water loading and unloading that can be adapted to any tank. Made of nylon. 90° elbow fitting.

Code	Version
52.199.16	Outlet or vent, hose adaptor Ø 16 mm
52.199.38	Load, hose adaptor Ø 38 mm

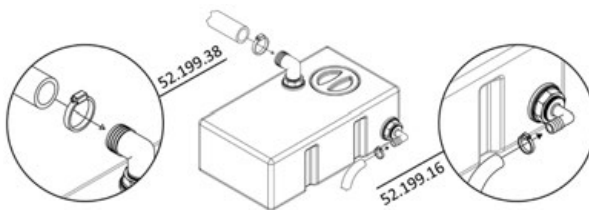

OSCULATI



### Hose adaptor

Made of **white nylon** for rigid water tanks.

Code	Version	Code	Version
52.197.15	3/4"x15 mm straight	52.195.38	1"1/4x38 mm straight
52.198.16	3/4"x16 mm 90° curve	52.196.38	1"1/4x38 mm 90° curve
52.198.25	3/4"x25 mm 90° curve	52.197.38	1"1/2x38 mm straight
52.195.15	1/2"x15 mm straight	52.198.38	1"1/2x38 mm 90° curve
52.196.15	1/2"x15 mm 90° curve		

Colour white or black depending on availability.



## Portable showers

### 20 litre solar shower



**Code** 52.020.20  
Made with special **PVC** that absorbs solar rays and heats the water that is stored inside; supplied with dispenser.

### Portable pressure "Handy Shower"



**Code** 52.187.00  
Fitted with **ABS** container that can hold up to 8 litres of water, push button shower and 1,7 meter hose, pressure piston; by activating the piston 25 times with pressure up to three bar, the water comes out of the shower; Handy Shower is well built and very functional.