

Deck equipment

Handrail (AISI 316)



PIJP



STEUN..

Stainless steel (AISI 316) handrail

Rail pipe and rail fittings available in Ø 20 mm and 25 mm. Pipe is available per metre. Fittings must be ordered separately, please see price list.

Type	Tube Ø	Wall thickness	Max. pipe length
PIJP	20	1,5	6000
PIJP25	25	1,5	6000

Type	Tube Ø	Support
STEUN20V	20	Front
STEUN20A	20	Rear
STEUN20M	20	Middle
STEUN25V	25	Front
STEUN25A	25	Rear
STEUN25M	25	Middle

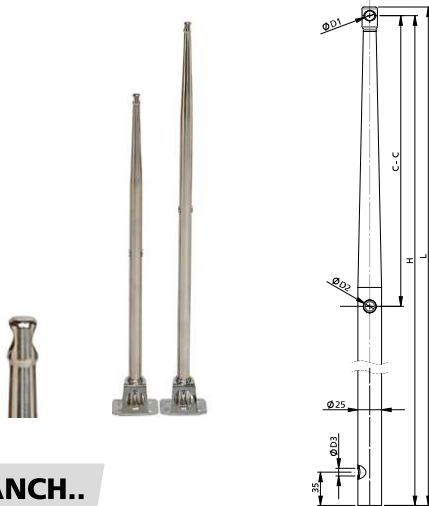

STANCH..

Stainless steel (AISI 316) stanchions

Tapered with two wire holes. Max. railing wire 9,5 mm.

Type	Length	Height	C - C	D1	D2	D3	Hole spacing
STANCH61	619	610	305	10,1	10,1	8	2 wire holes at 305 / 610
STANCH75	759	750	360	10,1	10,1	8	2 wire holes at 360 / 750



STANCHPR

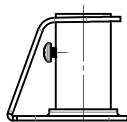

STANCHPS

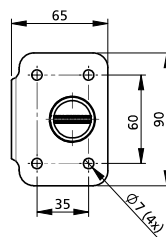
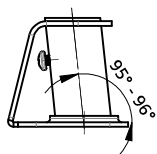

Stainless steel (AISI 316) stanchion sockets

Specifications

- Diameter: 25 mm
- 90° straight or with 6° angle

Type	Description
STANCHPR	Straight
STANCHPS	Angled

