

Stainless steel rollers

DOUGLAS MARINE AISI316 stainless steel bow shield

Mirror-polished AISI316 stainless steel bow shield, bored and countersunk. Supplied with a pre-fold, it adapts to the different bow shapes of boats when installed. With oversized thickness, it resists even the most violent impacts.

Douglas Marine

Code	Thickness	Dimensions mm	Weight
01.290.01	2	340x520	1.78
01.290.03	2	680x450	3

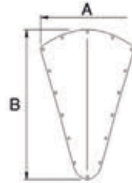

Bow roller for dolphin strikers

Made of **stainless steel 304** to be mounted **under** the bow roller.

Code	Sheave material	Recess fit width mm	Spare sheave	kg
01.119.92	Hard rubber	125	01.219.94	1.3

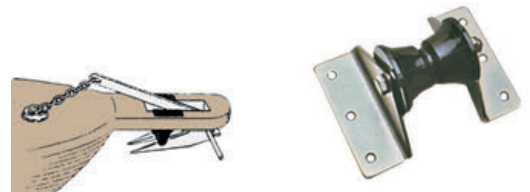
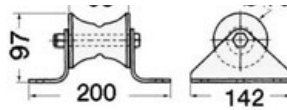

Bow roller, compact version

In **satín-finished 304 stainless steel**, with **nylon pulley**

Code	Length mm	Width mm	Height mm	Spare sheave	kg
01.118.82	155	51	72	01.218.82	0.48

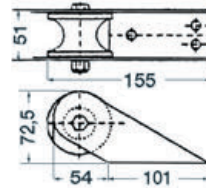

Bow fairlead

Very sturdy and practical, made of **AISI316 stainless steel**, **nylon** sheave suitable for ropes up to 14 mm and for chains up to 6/8 mm. Product by Osculati.

Code	Length mm	Base mm	kg
01.349.00	130	90x90	1.1



Bow roller with safety pin

In **satín-finished stainless steel 304**. Pulley in **hard rubber**.

Code	Length mm	Width with safety pin mm	Spare sheave	Anchor max weight kg	Ø kg	
					line mm	chain mm
01.118.83	280	55	01.218.82	15	24	10
01.118.91	231.5	51	01.218.82	15	24	10

