

Hinged bow roller with safety pin

AISI 316 Made of **stainless steel**, suitable for all anchors up to 14 kg. **Nylon** sheave.

Code	Length A mm	Width C mm	Height L mm	Spare sheave	
				large	small
01.419.00	320	90	70	01.519.01	01.519.02



Hinged bow roller with fairlead up to 10 kg

Made of **mirror-polished stainless steel** plate and fitted with tilted flap and **nylon** sheave. Suitable for CQR, Danforth, Bruce and Trefoil® anchors up to 10 kg.

Code	Length mm	Width mm
01.218.85	310	93.7



Hinged bow roller with fairlead up to 20 kg

Made of 4-mm thick **polished stainless steel** plate, fitted with chain guide, suitable for any type of anchor from 10 to 20 kg. **Stainless steel** sheave.

Code	A mm	B mm	C mm	D mm	E mm	L mm
01.337.00	416	230	186	114	47	81

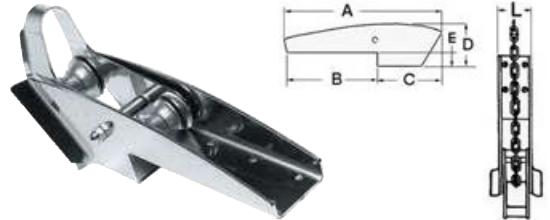

Self-locking roller

AISI 316 Suitable for Bruce and Trefoil® anchors, made of **mirror-polished precision-cast AISI 316 stainless steel**. Unbreakable **stainless steel** sheave, fitted with U-shape anchor stopper.

Code	A mm	B mm	C mm	L mm	For anchors up to max kg	For calibrated chains Ø mm
01.341.99	380	261	196	67	10	6/8
01.341.96	480	300	240	75	15	8/10
01.341.98	590	340	235	78	20	10/12
01.341.97	590	340	240	82	30	10/12

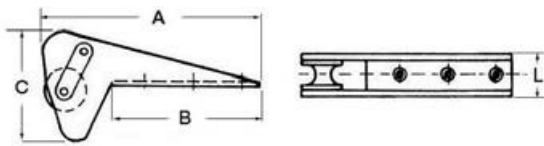

OSCOLATI



Shimming chock

AISI 316 Designed to ease anchor pay-out if the bow section does not allow for the correct angle of the anchor into the roller.

Code	L1 mm	For rollers
01.341.90	45	01.341.99
01.341.91	57	01.341.96/97/98



Special roller for Bruce and Trefoil® anchors

Made of **polished stainless steel** plate, this bow roller makes the most of the Bruce and Trefoil® anchor design to provide a **self-locking** feature. **Nylon** sheave.

Code	A mm	B mm	C mm	L mm	For
01.342.10	370	250	187	89	Bruce/Trefoil® up to 10 kg
01.342.20	542	375	250	88	Bruce/Trefoil® up to 20 kg

