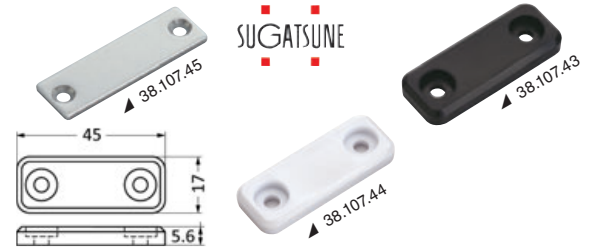

**SUGATSUNE sealed magnetic lock - flat mounting**

The magnet is completely sealed in resin and is absolutely stainless. Slim closure, ideal for tight spaces.

Code	Colour	Magnetic force in kgf	mm	Stainless steel backplate	
				Code	mm
38.107.43	Black	3	45x17x5.6	38.107.45	49x15
38.107.44	White	3	45x17x5.6	38.107.45	49x15

**SUGATSUNE sealed magnetic lock - angle mounting**

The magnet is embedded in the resin and is totally stainless.

Code	Colour	Magnetic force in kgf	mm	Stainless steel backplate	
				Code	mm
38.107.46	Black	3	50x21x13	38.107.45	49x15
38.107.47	White	3	50x21x13	38.107.45	49x15

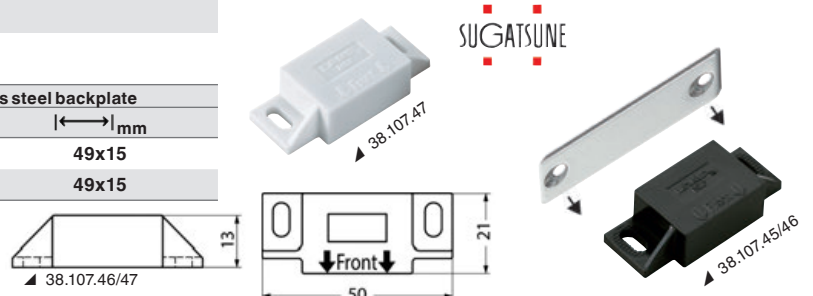
**SUGATSUNE snap lever latch**

Made of polyamide (PA). For doors without knobs or handles. Adjustable installation position ( $\pm 1.5$  mm horizontally or vertically).

Code	Colour	Retaining force N
38.191.10	Brown	196
38.191.11	White	196
38.191.12	Black	196

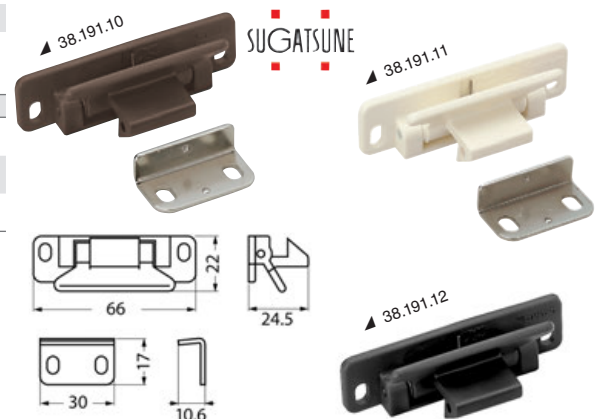
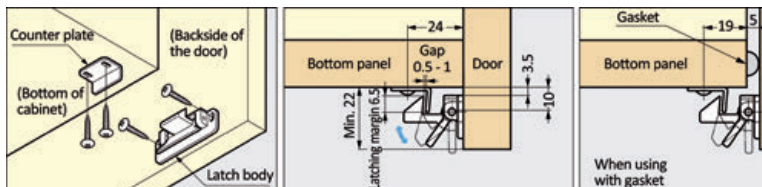
**New SUGATSUNE non-magnetic contact latch**

ABS body. For doors without knobs or handles. Non-magnetic. Latch release travel of about 1.5 mm.

Code	Colour	Retaining force N
38.194.01	Black	29

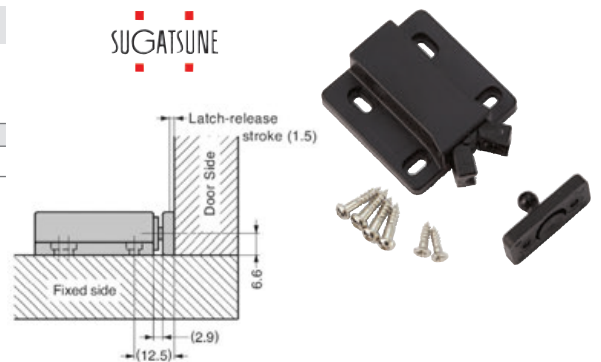
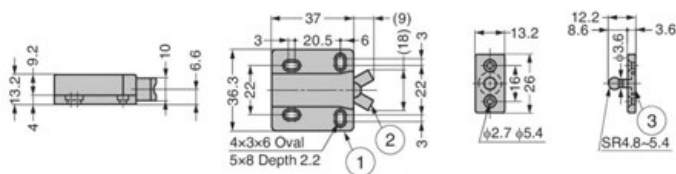
**New SUGATSUNE non-magnetic contact latch with floating door stop**

ABS body. For doors without knobs or handles. Floating collision for easy alignment. Non-magnetic. Latch release travel of about 3 mm

Code	Colour	Retaining force N
38.199.01	Black	78
38.199.02	White	78

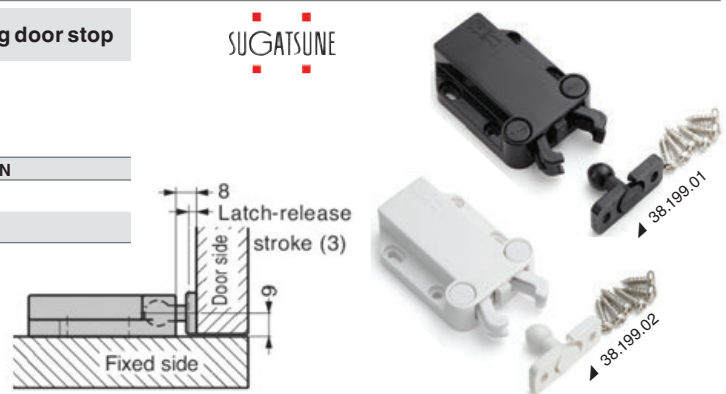
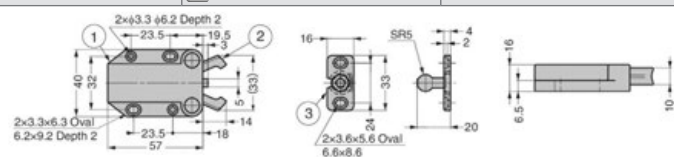
**Cabinet door snap lock**

Made of **stainless steel** and **ABS**; it may be opened or closed by lightly tapping on it from the outside; universal model.

Code	mm	Thickness mm	ORDER BY BOX
38.107.42	46x27	10	5

