

**Snap-in door stopper**Made of **nylon and rubber**.

Code	Colour	Base Ø mm	Total hangover mm	
38.422.88	white	50	17	10 pcs

**New****Magnetic door stop****AISI 316****FLUSH****PATENTED (UTILITY MODEL)****Code** 38.155.80

Magnetic doorstop consisting of two components: door block with 18° inclined magnet and ground block with retractable plate.

The magnet lifts the plate when the door is approaching and the block is activated.

When not in use, the plate automatically returns to a flat, recessed, obstacle-free position.

Equipped with shock and anti-vibration gaskets and a set of 2 gaskets (2 mm and 4 mm) to adjust the ground block height as required.

For 4 to 10 mm floor height doors stops.

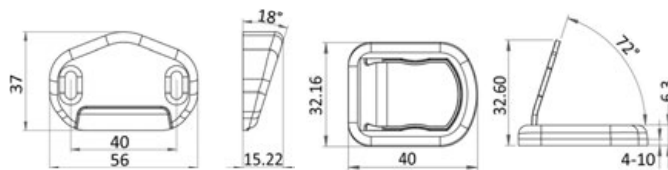
**OSCULATI**

Video

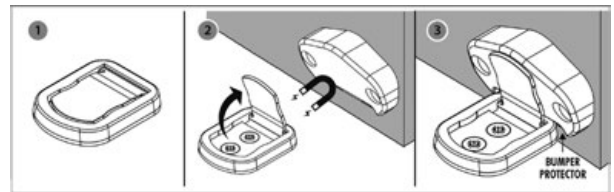
**Adjustable magnetic doorstop**

Code	Version	Description
38.155.00	chromed brass	Standard magnetic resistance 4.1 Kg
38.155.01	Stainless Steel 316 mirror-polished	Standard magnetic resistance 4.1 Kg
38.155.10 <b>New</b>	chromed brass	GIANT magnetic resistance 7.5 Kg

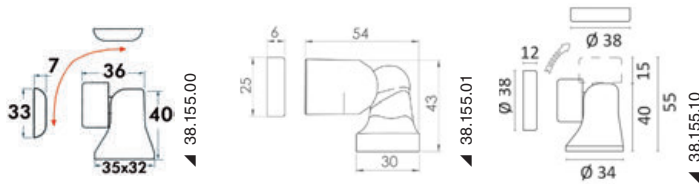
**OSCULATI****Magnetic doorstop**Made of **brass**, fitted with checking plate.

Code	Ø mm	H mm	Version	Description
38.155.20	40	35	chromed brass	Standard - magnetic resistance 4.1 Kg - internal use
38.155.21 <b>New</b>	39	25	chromed brass	Giant - magnetic resistance 7.5 Kg - outdoor use

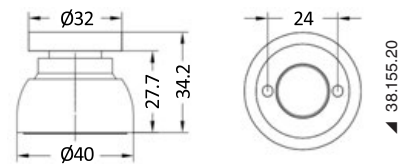
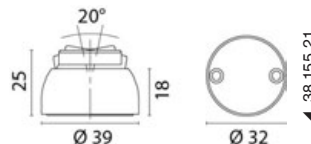
**Telescopic magnetic doorstop**

Made of **brass**, fitted with checking plate; adjustable from 50 to 82 mm.

Code	Version
38.155.30	chromed brass

**Doorstop**

Made of **chromed brass**, leaf with terminal vibration dampening rubber top.

Code	Base Ø mm	Total length mm
38.154.00	40	50

Video