

BOW ROLLERS

HINGED BOW ROLLER

Suitable for rope and chain anchor rodes utilising up to 13 mm (1/2") chain.



HINGED BOW ROLLER DIMENSIONS

Code	Type	L	B	H	h	C
P104330	Size 1	320 mm (12 5/8")	92 mm (3 5/8")	72 mm (2 7/8")	133 mm (5 1/4")	44 mm (1 3/4")
P104331	Size 2	430 mm (16 15/16")	160 mm (5 5/16")	100 mm (4")	190 mm (7 1/2")	66 mm (2 11/16")

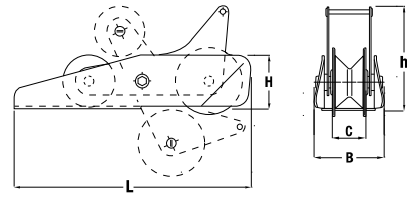

FIXED BOW ROLLER

Suitable for rope and chain anchor rodes utilising up to 13 mm (1/2") chain.



FIXED BOW ROLLER DIMENSIONS

Code	Type	L	B	H	C
P104332	Size 1	205 mm (8 1/8")	72 mm (2 7/8")	74 mm (3")	44 mm (1 3/4")
P104333	Size 2	320 mm (12 5/8")	86 mm (3 7/16")	74 mm (3")	44 mm (1 3/4")
P104334	Size 3	444 mm (17 1/2")	110 mm (4 3/8")	110 mm (4 3/8")	68 mm (2 11/16")

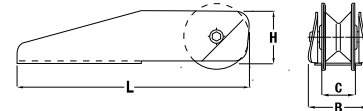

CHAIN STOPPERS

Taking the load off the windlass

Chain stoppers hold the chain and take the load off the windlass. Always use a chain stopper to set and ride on the anchor, break free the anchor or to prevent accidental free fall of the anchor while under way.

To suit any installation configuration of chain stoppers and windlass combinations, Maxwell offers three types of chain stoppers: Height Matched, Levered and Economy.



CHAIN STOPPER DIMENSIONS

	Height Matched		Levered			Economy
	RC8/10 (P104358)	RC12 (P104359)	8 mm (P104372)	10 mm (P104373)	13 mm (P104374)	8/10 mm (P104335)
B	105 mm (4 1/8")	127 mm (5")	72 mm (2 7/8")	86 mm (3 7/16")	105 mm (4 3/16")	62 mm (2 3/8")
C	40 mm (1 9/16")	48 mm (1 7/8")	20 mm (7/8")	20 mm (7/8")	26 mm (1 1/8")	6 mm (1/4")
F	150 mm (5 15/16")	182 mm (7 3/16")	152 mm (6")	190 mm (7 1/2")	219 mm (8 5/8")	80 mm (3 1/8")
G	130 mm (5 1/8")	159 mm (6 1/4")	92 mm (3 5/8")	130 mm (5 1/8")	159 mm (6 5/16")	46 mm (1 3/4")
Gⁱ	10 mm (7/16")	11.5 mm (1/2")	30 mm (1 3/16")	30 mm (1 3/16")	30 mm (1 3/16")	17 mm (5/8")
I	77 mm (3")	97 mm (3 13/16")	70 mm (2 7/8")	86 mm (3 1/2")	100 mm (4")	92 mm (3 5/8")
J	44 mm (1 3/4")	53 mm (2")	31.5 mm (1 1/4")	44 mm (1 3/4")	53 mm (2 1/8")	N/A
Jⁱ	8.8 mm (11/32")	12.5 mm (1/2")	10 mm (7/16")	10 mm (7/16")	12.5 mm (1/2")	37 mm (1 1/2")
K	61.5 mm (2 7/16")	78 mm (3")	51.5 mm (2 1/8")	64 mm (2 5/8")	78 mm (3 1/8")	74 mm (2 7/8")
L	90 mm (3 1/2")	125 mm (4 15/16")	95 mm (3 3/4")	95 mm (3 3/4")	130 mm (5 1/8")	N/A
M	M8	M10	M10	M10	M12	M10

STOPPER TENSIONER

The 10-13 mm chain stopper is now available with integral anchor tensioner which is used to pull the stowed anchor tightly into the bow roller or anchor pocket preventing unwanted noise from the anchor moving in the anchor pocket.

A retro-fit kit is available to fit the tensioner assembly onto existing Maxwell 10-13 mm chainstopper bodies.



P105257 - Stopper Tensioner 10-13 mm Removable Lever

P104740 - Stopper Tensioner Retrofit Kit for 13 mm Chainstoppers

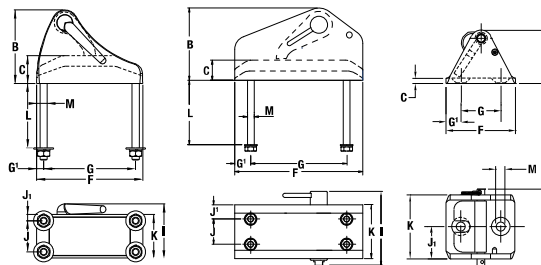

WEBBING TENSIONER

Also available is a webbing strap tensioner for use on 7-12 mm chains. The webbing tensioner simply fits to a deck cleat/bollard and uses a stainless steel (AISI 316) claw to grip the chain and an over center cam lock to tension and secure the anchor.

P105072 - Webbing Tensioner 7-12 mm



INTERMEDIATE ROLLER

Designed for use with Tasman drum windlasses.

P105093

130 mm wide for 6 or 8 mm chain

P105094

180 mm wide for 6 or 8 mm chain

