



# Compact 3500/4000/4200

HR3500  
Jaguar



Model	HR3500 Jaguar	HR4000 Thor	HR4200 Thor
VESSEL LENGTH	<b>14 - 20m</b> 45 - 65ft	<b>18 - 24m</b> 58 - 77ft	<b>18 - 25m</b> 58 - 80ft
POWER SUPPLY (DC)	<b>12/24V</b>	<b>24V</b>	<b>24V</b>
MOTOR (Watts)	1500	1500	2000
HYDRAULIC PRESSURE	<b>10MPa</b> 1450PSI	<b>12MPa</b> 1750PSI	<b>12MPa</b> 1750PSI
HYDRAULIC FLOW	<b>28L/min</b> 7.5gal/min	<b>28L/min</b> 7.5gal/min	<b>28L/min</b> 7.5gal/min
MAX LOAD	<b>1590kg</b> 3500lb	<b>1818kg</b> 4000lb	<b>2045kg</b> 4500lb
WORK LOAD	<b>400kg</b> 800lb	<b>454kg</b> 1000lb	<b>500kg</b> 1100lb
AMPS WORK LOAD	150/85	150/85	120
MAX LINE SPEED	<b>15m/min</b> 48ft/min	<b>13.5m/min</b> 44ft/min	<b>13.5m/min</b> 44ft/min
CHAIN SIZE	<b>8 - 10 - 13mm</b> 5/16 - 3/8 - 1/2"	<b>10 - 13 - 16mm</b> 3/8 - 1/2 - 5/8"	<b>10 - 13 - 16mm</b> 3/8 - 1/2 - 5/8"
NET WEIGHT	<b>DC 58kg HYD 57kg</b> DC 128lb HYD 125lb	<b>DC64kg HYD63kg</b> DC140lbHYD139lb	<b>DC64kgHYD63kg</b> DC140lbHYD139lb
MANUAL OPERATION	<b>MORS (std)</b>	<b>MORS (std)</b>	<b>MORS (std)</b>

Note: Rope can also be used but is not recommended for larger vessels.

### Features

- Rope chain combination gypsy for rope & chain combination or chain only
- Manual Override System (MORS)
- Gypsy lock/pawl
- Cleat on housing
- Heavy duty dual direction motor in 12 & 24V DC, Hydraulic
- Durable marine grade white gloss finish alloy housing
- Fully enclosed motor & gearbox
- Independent gypsy and capstan operation
- Luxury chromed marine grade bronze / 316 Stainless steel running gear
- Stainless steel drive shaft
- Cone clutch/brake
- Shaft seal
- Clutch release handle
- Installation/Operation booklet



### Options

- Twin gypsy, twin capstan
- Rope Chain Management System (RCMS)
- Housing without cleat
- Traditional polished bronze finish on running gear
- Full range of accessories including chain, rope, anchors, anchor roller, chain pipes, chain stoppers, snubber kits & devil claws
- Electric & hydraulic operating options & accessories
- Auto anchor

HR4000/4200  
Thor

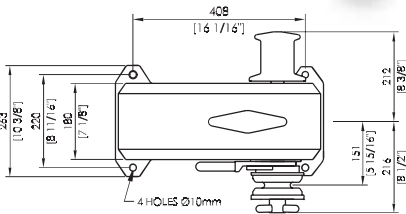

HR3500  
Jaguar

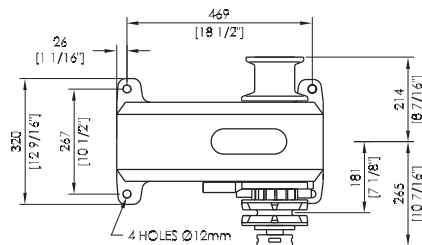
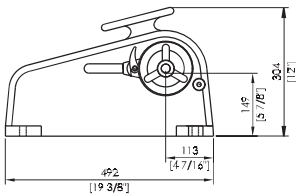

HR4000/4200  
Thor

